

355390 f = 2.75 mm and 0.55 NA

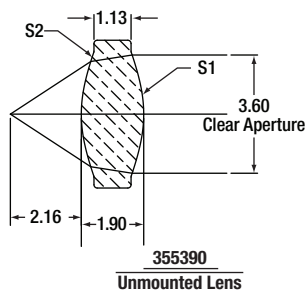

355390
Unmounted Lens

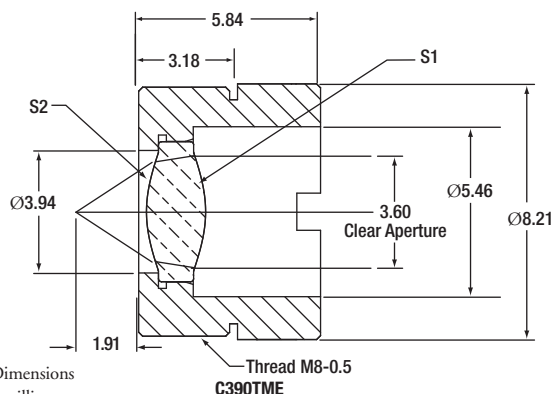

All Dimensions are in millimeters

C390TME
Mounted Lens

Geltech™ Molded Glass Aspheric Collimator Lens

Optical Design Specifications

- Design Wavelength: 830 nm
- Numerical Aperture: 0.55
- Clear Aperture: Ø3.60 mm
- Effective Focal Length: 2.75 mm
- Unmounted Working Distance: 2.16 mm
- Mounted Working Distance: 1.91 mm
- Magnification: Infinite
- Diffraction-Limited Range: 755 – 955 nm
- Surface Quality: 40-20 Scratch-Dig
- Glass: D-ZLAF52LA

Geltech™ lenses are manufactured by LightPath® Technologies

Aspheric Coefficients

	R	k	A ₄	A ₆	A ₈	A ₁₀	A ₁₂
ASP (1)	3.879161	-0.4317287	-0.0081688989	-1.99569030E-04	2.2009330E-04	-3.98208390E-05	2.65661150E-06
ASP (2)	-3.879161	-0.4317287	0.0081688989	1.99569030E-04	-2.2009330E-04	3.98208390E-05	-2.65661150E-06

Please refer to our website for complete models and drawings.

Unmounted, AR-Coated Aspheric Lenses

ITEM #	\$	£	€	RMB	DESCRIPTION
355390-A	\$ 69.00	£ 49.68	€ 60,03	¥ 549.93	Lens, AR-Coated: 400 – 600 nm
355390-B	\$ 69.00	£ 49.68	€ 60,03	¥ 549.93	Lens, AR-Coated: 600 – 1050 nm
355390-C	\$ 69.00	£ 49.68	€ 60,03	¥ 549.93	Lens, AR-Coated: 1050 – 1620 nm

Mounted, AR-Coated Aspheric Lenses

ITEM #	\$	£	€	RMB	DESCRIPTION
C390TME-A	\$ 74.00	£ 53.28	€ 64,38	¥ 589.78	Mounted Lens, AR-Coated: 400 – 600 nm
C390TME-B	\$ 74.00	£ 53.28	€ 64,38	¥ 589.78	Mounted Lens, AR-Coated: 600 – 1050 nm
C390TME-C	\$ 74.00	£ 53.28	€ 64,38	¥ 589.78	Mounted Lens, AR-Coated: 1050 – 1620 nm

352440 f = 2.95 mm, 0.53 NA Object, and 0.27 NA Image

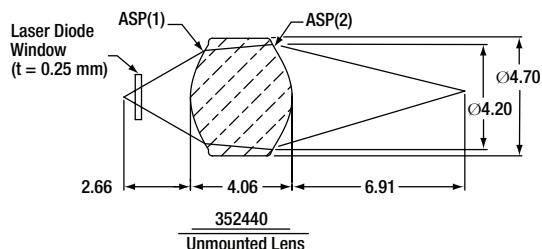

352440
Unmounted Lens

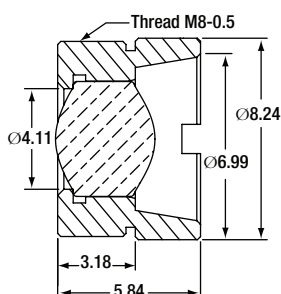

C440TME
Mounted Lens

All Dimensions are in millimeters
Laser Diode Window Not Included

Please refer to our website for complete models and drawings.

Aspheric Coefficients

	R	k	A ₄	A ₆	A ₈	A ₁₀
ASP (1)	2.40	-4.456395	-5.2675614E-03	1.0753165E-03	-3.2335319E-04	2.5517886E-05
ASP (2)	-2.39	-0.8371770	-7.3100129E-03	-3.9100155E-04	1.2597638E-04	-2.6451531E-05

Unmounted, AR-Coated Aspheric Lenses

ITEM #	\$	£	€	RMB	DESCRIPTION
352440-A	\$ 69.00	£ 49.68	€ 60,03	¥ 549.93	Lens, AR-Coated: 400 – 600 nm
352440-B	\$ 69.00	£ 49.68	€ 60,03	¥ 549.93	Lens, AR-Coated: 600 – 1050 nm
352440-C	\$ 69.00	£ 49.68	€ 60,03	¥ 549.93	Lens, AR-Coated: 1050 – 1620 nm

Mounted, AR-Coated Aspheric Lenses

ITEM #	\$	£	€	RMB	DESCRIPTION
C440TME-A	\$ 74.00	£ 53.28	€ 64,38	¥ 589.78	Mounted Lens, AR-Coated: 400 – 600 nm
C440TME-B	\$ 74.00	£ 53.28	€ 64,38	¥ 589.78	Mounted Lens, AR-Coated: 600 – 1050 nm
C440TME-C	\$ 74.00	£ 53.28	€ 64,38	¥ 589.78	Mounted Lens, AR-Coated: 1050 – 1620 nm



Geltech™ Molded Glass Aspheric Collimator Lens

Optical Design Specifications

- Design Wavelength: 980 nm
- Numerical Aperture:
 - Image Side: 0.27
 - Object Side: 0.53
- Clear Aperture
 - Image Side: Ø4.2 mm
 - Object Side: Ø4.0 mm
- Effective Focal Length: 2.95 mm
- Unmounted WD:
 - Image Side: 6.91 mm
 - Object Side: 2.66 mm
- Mounted WD:
 - Image Side: 5.04 mm
 - Object Side: 2.84 mm
- Magnification: ∞
- Diffraction-Limited Range: 895 – 1125 nm
- Laser Window Thickness: 0.25 mm
- Laser Window Material/Index: N-BK7/1.508 @ 980 nm
- Surface Quality: 40-20 Scratch-Dig
- Glass: ECO-550

Geltech™ lenses are manufactured by LightPath® Technologies

AR Coating Plots Page 717