

## Optomechanics

### Adapter Ring

SD1



Screw Not Included

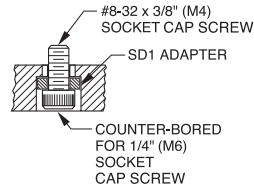

The SD1 Adapter Ring allows an #8-32 (M4) socket screw to be used in a mounting hole that was counterbored for a 1/4"-20 (M6) socket screw. These adapters are sold in packages of 10.

| ITEM# | \$*     | £*     | €*     | RMB*    | DESCRIPTION                  |
|-------|---------|--------|--------|---------|------------------------------|
| SD1   | \$ 7.00 | £ 4.40 | € 6,50 | ¥ 66.90 | Adapter Ring, 10 pc. Package |

\*Universal Design, Imperial and Metric Compatible

### Micrometer Barrel Adapters



RBA1

These three slotted brass sleeves are an ideal solution for securing Ø3/8" and Ø10mm mounting barrels into components designed for Ø1/2" and Ø0.47" barrels. The slotted sleeve allows an externally applied clamping force to be transferred to the mounting barrel.



Micrometer Sold Separately

| ITEM# | \$      | £      | €      | RMB     | DESCRIPTION                |
|-------|---------|--------|--------|---------|----------------------------|
| RBA1  | \$ 6.85 | £ 4.30 | € 6,40 | ¥ 65.40 | Ø0.375" to Ø0.500" Adapter |
| RBA2  | \$ 6.85 | £ 4.30 | € 6,40 | ¥ 65.40 | Ø10mm to Ø0.500" Adapter   |
| RBA3  | \$ 6.85 | £ 4.30 | € 6,40 | ¥ 65.40 | Ø0.375" to Ø0.470" Adapter |

### Thread Adapters

#### External to External

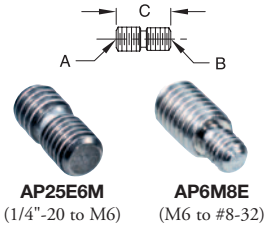

AP25E6M  
(1/4"-20 to M6)

AP6M8E  
(M6 to #8-32)

| ITEM#   | \$      | £      | €      | RMB     | THREAD "A" | THREAD "B" | LENGTH "C"   |
|---------|---------|--------|--------|---------|------------|------------|--------------|
| AP6M4M  | \$ 1.60 | £ 1.00 | € 1,50 | ¥ 15.30 | M6         | M4         | 0.57" (15mm) |
| AP6M8E  | \$ 1.60 | £ 1.00 | € 1,50 | ¥ 15.30 | M6         | #8-32      | 0.57" (15mm) |
| AP8E25E | \$ 1.60 | £ 1.00 | € 1,50 | ¥ 15.30 | #8-32      | 1/4"-20    | 0.57" (15mm) |
| AP25E6M | \$ 1.60 | £ 1.00 | € 1,50 | ¥ 15.30 | 1/4"-20    | M6         | 0.57" (15mm) |
| AP8E4E  | \$ 1.78 | £ 1.10 | € 1,70 | ¥ 17.00 | #8-32      | #4-40      | 0.38" (10mm) |
| AP4M3M  | \$ 1.78 | £ 1.10 | € 1,70 | ¥ 17.00 | M4         | M3         | 0.38" (10mm) |

**STAINLESS STEEL**

#### Internal to External

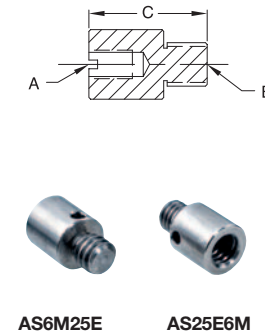

AS6M25E

AS25E6M

| ITEM#   | \$      | £      | €      | RMB     | THREAD "A" | THREAD "B" | LENGTH "C"   |
|---------|---------|--------|--------|---------|------------|------------|--------------|
| AS4M8E  | \$ 4.00 | £ 2.50 | € 3,70 | ¥ 38.20 | M4         | #8-32      | 0.56" (14mm) |
| AS8E4M  | \$ 4.00 | £ 2.50 | € 3,70 | ¥ 38.20 | #8-32      | M4         | 0.56" (14mm) |
| AS6M25E | \$ 4.00 | £ 2.50 | € 3,70 | ¥ 38.20 | M6         | 1/4"-20    | 0.63" (16mm) |
| AS25E6M | \$ 5.00 | £ 3.15 | € 4,70 | ¥ 47.80 | 1/4"-20    | M6         | 0.63" (16mm) |
| AS25E8E | \$ 4.60 | £ 2.90 | € 4,30 | ¥ 43.90 | 1/4"-20    | #8-32      | 0.61" (15mm) |
| AS6M4M  | \$ 4.00 | £ 2.50 | € 3,70 | ¥ 38.20 | M6         | M4         | 0.61" (15mm) |
| AS25E4M | \$ 4.00 | £ 2.50 | € 3,70 | ¥ 38.20 | 1/4"-20    | M4         | 0.61" (15mm) |
| AS6M8E  | \$ 4.00 | £ 2.50 | € 3,70 | ¥ 38.20 | M6         | #8-32      | 0.61" (15mm) |
| AS8E25E | \$ 4.00 | £ 2.50 | € 3,70 | ¥ 38.20 | #8-32      | 1/4"-20    | 0.68" (17mm) |
| AS4M6M  | \$ 4.60 | £ 2.90 | € 4,30 | ¥ 43.90 | M4         | M6         | 0.68" (17mm) |
| AS4M25E | \$ 4.00 | £ 2.50 | € 3,70 | ¥ 38.20 | M4         | 1/4"-20    | 0.68" (17mm) |
| AS8E6M  | \$ 4.00 | £ 2.50 | € 3,70 | ¥ 38.20 | #8-32      | M6         | 0.68" (17mm) |

**STAINLESS STEEL**

#### Internal to External Threaded Stud

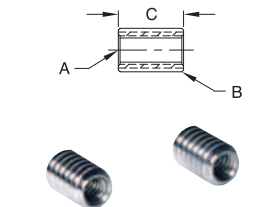

| ITEM#   | \$      | £      | €      | RMB     | THREAD "A" | THREAD "B" | LENGTH "C"   |
|---------|---------|--------|--------|---------|------------|------------|--------------|
| AE8E25E | \$ 4.00 | £ 2.50 | € 3,70 | ¥ 38.20 | #8-32      | 1/4"-20    | 0.38" (10mm) |
| AE4M6M  | \$ 3.50 | £ 2.20 | € 3,30 | ¥ 33.40 | M4         | M6         | 0.39" (10mm) |
| AE4M25E | \$ 3.50 | £ 2.20 | € 3,30 | ¥ 33.40 | M4         | 1/4"-20    | 0.38" (10mm) |
| AE8E6M  | \$ 4.00 | £ 2.50 | € 3,70 | ¥ 38.20 | #8-32      | M6         | 0.39" (10mm) |

**STAINLESS STEEL**

#### Internal to Internal

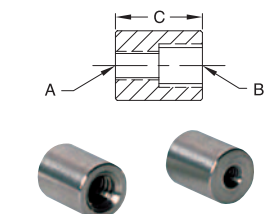

| ITEM#   | \$      | £      | €      | RMB     | THREAD "A" | THREAD "B" | LENGTH "C"  |
|---------|---------|--------|--------|---------|------------|------------|-------------|
| AI25E8E | \$ 4.60 | £ 2.90 | € 4,30 | ¥ 43.90 | 1/4"-20    | #8-32      | 0.5" (13mm) |
| AI6M4M  | \$ 4.60 | £ 2.90 | € 4,30 | ¥ 43.90 | M6         | M4         | 0.5" (13mm) |
| AI25E4M | \$ 4.60 | £ 2.90 | € 4,30 | ¥ 43.90 | M4         | 1/4"-20    | 0.5" (13mm) |
| AI6M8E  | \$ 4.60 | £ 2.90 | € 4,30 | ¥ 43.90 | M6         | #8-32      | 0.5" (13mm) |

**STAINLESS STEEL**

Visit [www.thorlabs.com](http://www.thorlabs.com) For Mechanical Drawings and Our New Solid Models

